





#### COMPONENTS:

- 2 Connector Clips
- 4 Plugs



#### PLEASE NOTE:

One connector kit connects two bins to each other.  
For large stations, additional connector kits will be required.



- 1 Line up containers to be connected.  
Be sure to line up the pre-drill markings side-by-side as this is where sign frames will be installed if applicable. Even if no sign frames are being installed, it is recommended to line all bins up the same way for consistency.

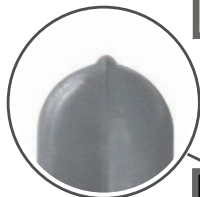

Tip Facing  
Inward

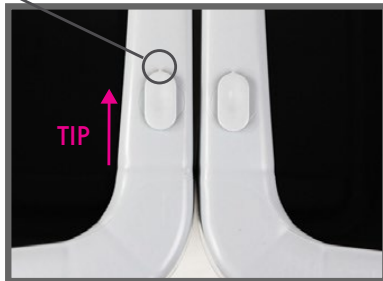

- 2 Insert plugs with **pointed tip facing towards the center of the bin** as shown. Front plugs face back and back plugs will face forward. This is VERY IMPORTANT as if the plug is not set in the right position it will not securely fit and lock with the Connector Clip.

**Best selection, lowest prices.**

Call us for Quantity Discounts and Custom Designs!

800.664.5340 [www.recycleaway.com](http://www.recycleaway.com)

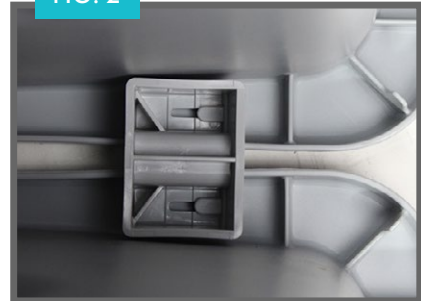
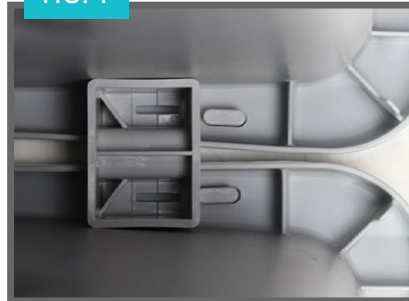

- 3 Place Connector Clip under rim past where plug ends are located. (FIG. 1)  
Place each plug end into the slots in the Connector Clip and slide toward the outside of the container until it 'clicks' into place. (FIG. 2)
- 4 Repeat process for all connection locations.

***Best selection, lowest prices.***

Call us for Quantity Discounts and Custom Designs!

800.664.5340 [www.recycleaway.com](http://www.recycleaway.com)